



MOTOPOMPE INCENDIE
EUROMAST FIRE PUMPS

EN

FIRE **PUMPS**





Leader in the manufacturing and distribution of

FIRE FIGHTING PUMPS

HIGH PRESSURE AND LOW PRESSURE

- **PORTABLE FIRE PUMPS**
- **PUMPS FOR FOREST FIRE**
- **TEST PUMPS**
- **FIXED MOTOR PUMP GROUPS FIRE PROTECTION**
- **TOWABLE PUMPS**
- **FLEXIBLE AND RIGID TANKS**
- **FIRE HOSES**
- **FIRE NOZZLES**
- **MONITORS**

TEAM UP TO BE SAFER

The emergency sector is a constant challenge. We interpret it literally by questioning ourselves every day in thinking of machines that guarantee a higher level of safety and performance.

That is why our multifunctional motor pumps and electric pumps, lighting towers and generators are used by civil defense and firefighters around the world for their efficiency, durability and reliability. A wide range of highly customizable products is the guarantee of your safety.



INNOVATIVE PRODUCTS

- research and development
- designs, models



ADAPTED TO YOUR NEEDS

- highly personalized solutions and tailor-made products



**PROMPT AND SECURE
PAYMENT**



**FREE QUOTE
WITHIN 24 HOURS**



**INTERNATIONAL
DELIVERY**



**AVAILABLE PRODUCTS
QUICKLY**



Summary



01

**MOTOR FIRE
PUMPS**

Page 4



06

**FLOOD
TRAILERS**

Page 28



02

**MOTOR FLOATING
PUMPS**

Page 10



07

**FIRE
NOZZLES**

Page 34



03

**EXHAUST MOTOR
PUMPS**

Page 14



08

**FIRE
HOSES**

Page 38



04

**MOTOR PUMPS FOR
TESTING DRY COLUMNS**

Page 20

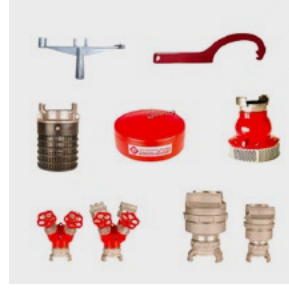

09

**KEYS, TAPS
ACCESSORIES**

Page 42



05

**HIGH PRESSURE
FIRE KITS**

Page 24

001

MOTOR FIRE PUMPS

Discover our range of portable fire pumps with petrol or diesel engines. Lightweight, powerful, efficient, durable, these are just some of the qualifiers describing our range of high pressure pumps.

All motor pumps can be sold ready to install, in kit form or on a trailer.





DIESEL FIRE PUMP ELECTRIC START

EFP-400/14-D-E



FEATURES

ENGINE

ENGINE REFERENCE	195FE
FUEL	Diesel
STARTER	Electric + manual emergency
FUEL TANK	5.5 L
POWER	15 hp / 11 Kw

PUMP

MAX FLOW RATE	400 l/min
PERFORMANCES	200 l/min at 10 bar 315 l/min at 6 bar
DIAM SUCTION	2" female
DIAM DISCHARGE	2" female
PUMP BODY AND TURBINE	Font
PRIMING	Charging (by gravity) Electric priming optional
DIMENSIONS	64 X 54 X 62,5 cm
WEIGHT	110 KG



PRESSURE
Up to 14 bar



PUMP FLOW RATE
Up to 400 l/min



WATER COMPATIBILITY
Clear waters

DIESEL FIRE PUMP ELECTRIC START

EFP-550-8-D-E



FEATURES

ENGINE

ENGINE REFERENCE	186FA
FUEL	Diesel
STARTER	Electric + manual emergency
FUEL TANK	5.5 L
POWER	13 hp / 7.5 Kw

PUMP

MAX FLOW RATE	584 l/min
PERFORMANCES	250 l/min at 6 bar 410 l/min at 3 bar
DIAM SUCTION	2" female
DIAM DISCHARGE	2" female
PUMP BODY AND TURBINE	Aluminum
PRIMING	Charging (by gravity) Electric opriming ptional
DIMENSIONS	64 X 50 X 52,5 cm
WEIGHT	89 KG



PRESSURE
Up to 8.5 bar



PUMP FLOW RATE
Up to 584 l/min



WATER COMPATIBILITY
Clear water

GASOLINE FIRE PUMP

EFP-900-6P



FEATURES

ENGINE

ENGINE REFERENCE	Briggs & Stratton - 2 cylinder 4 stroke
FUEL	Gasoline
STARTER	Electric 12V + emergency manual
TANK	8 L
POWER	23 hp / 17 Kw

PUMP

MAX FLOW RATE	2000 l/min
PERFORMANCES	864 l/min at 6 bar 1072 l/min at 5 bar
DIAM SUCTION	4" male
DIAM DISCHARGE	2" 1/2 male
PUMP BODY AND TURBINE	Aluminum
PRIMING	Exhaust gas
DIMENSIONS	75 X 56 X 70 cm
WEIGHT	76.2 KG



PRESSURE
Up to 10 bar



PUMP FLOW RATE
Up to 2000 l/min



WATER COMPATIBILITY
Clear waters

FIRE PUMP FOR SEAWATER

EFP-900-6BS-M

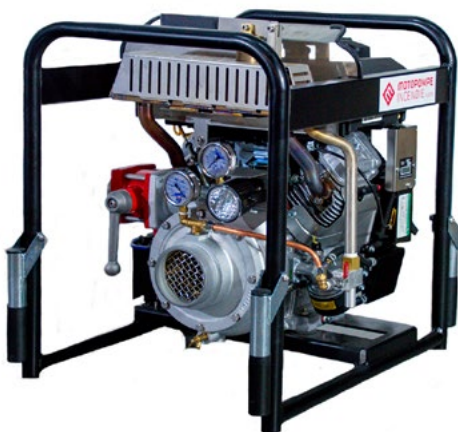

FEATURES

ENGINE

ENGINE REFERENCE	Briggs & Stratton - 2 cylinder 4 stroke
FUEL	Gasoline
STARTER	Electric 12 V + emergency manual
FUEL TANK	8 L
POWER	23 hp / 17 Kw

PUMP

MAX FLOW RATE	2000 l/min
PERFORMANCES	864 l/min at 6 bar 1072 l/min at 5 bar
DIAM SUCTION	4" male
DIAM DISCHARGE	2" 1/2" male
PUMP BODY AND TURBINE	Aluminum alloy in marine grade
PRIMING	Exhaust gas
DIMENSIONS	75 X 56 X 70 cm
WEIGHT	79.2 KG



PRESSURE
Up to 10 bar



PUMP FLOW RATE
Up to 2000 l/min



WATER COMPATIBILITY
Seawater



COMPACT PORTABLE FIRE PUMP

EFP-1400-200



FEATURES

ENGINE

ENGINE REFERENCE	Kholer KD 425
FUEL	2 cylinder Diesel
STARTER	Electric 12 V + emergency manual
TANK	4 L
POWER	19 hp / 14 Kw

PUMP

MAX FLOW RATE	1400 l/min
PERFORMANCES	1100 l/min at 4 bar 450 l/min at 8 bar
DIAM SUCTION	4" BSRT or 3"1/2 BSP Female
DIAM DISCHARGE	2 x 2"1/2 male
PUMP BODY AND TURBINE	Aluminum alloy in marine grade
PRIMING	Exhaust gas
DIMENSIONS	80 X 53 X 58 cm
WEIGHT	114 KG



PRESSURE
Up to 8 bar



PUMP FLOW RATE
Up to 1400 l/min



WATER COMPATIBILITY
Seawater

MOBILE FIRE PUMP

EFP-2500-300



FEATURES

ENGINE

ENGINE REFERENCE	OHV 4JB1 2-cylinder 4-stroke
FUEL	Diesel
STARTER	Electric
FUEL TANK	16 L
POWER	76 hp / 57 Kw

PUMP

MAX FLOW RATE	2500 l/min
PERFORMANCES	1500 l/min at 8 bar 2000 l/min at 7 bar
DIAM SUCTION	2 x 2"1/2 Female
DIAM DISCHARGE	2"1/2 male
PUMP BODY	Aluminum alloy in marine grade
PRIMING	Exhaust gas
DIMENSIONS	102 X 60,5 X 76 cm
WEIGHT	321 KG



PRESSURE
Up to 10 bar



PUMP FLOW RATE
Up to 2500 l/min



WATER COMPATIBILITY
Seawater

FIRE PUMP HOME DEFENDER TROLLEY KIT

KIT-HOME DEFENDER



FEATURES

ENGINE

ENGINE REFERENCE	Loncin
FUEL	Petrol - 4 stroke
STARTER	Manual
FUEL TANK	6.5 L
POWER	14 hp / 10 Kw

PUMP

MAX FLOW RATE	500 l/min
PERFORMANCES	350 l/min at 6 bar 420 l/min at 4 bar
DIAM SUCTION	2" male
DIAM DISCHARGE	2" male
PUMP BODY	Font
PRIMING	Self-priming (filling pump body)
DIMENSIONS	65 X 53 X 59 cm
WEIGHT	62 KG

KIT PROVIDED

- **3 positions launcher** (closed, straight and mist jet),
- **Discharge pipe** (40m),
- **Suction pipe** (6m),
- **1 strainer**



PRESSURE
Up to 10 bar



PUMP FLOW RATE
Up to 500 l/min



WATER COMPATIBILITY
Clear waters

FIRE PUMP AUTONOMOUS KIT HOME DEFENDER

KIT-HOME-DEFENDER-N



Specially from signed to protect your home in the event of a forest fire.

FEATURES

ENGINE

ENGINE REFERENCE	EUROMAST 170F
FUEL	Gasoline
STARTER	Manual
FUEL TANK	3.6 L
POWER	7 Hp

PUMP

MAX FLOW RATE	30 m3/h
MAX PRESSURE	6,5 bar
DIAM SUCTION	2" (DN50)
DIAM DISCHARGE	2" (DN50)
SUCTION HEIGHT	7 m
PRIMING	Self-priming (filling pump body)
DIMENSIONS	64 X 54 X 90 cm
WEIGHT	49 KG

KIT FOURNI

- **2 positions launcher** (traight jet or diffused jet),
- **Discharge pipe** (2x20m),
- **Suction pipe** (7m),
- **1 strainer**



PRESSURE
Up to 6,5 bar



PUMP FLOW RATE
Up to 30 m3/h



WATER COMPATIBILITY
Clear waters



MOTOPOMPE INCENDIE PORTABLE HAUTE PRESSION

EFP-1000-10-B

Certified to EN 14466, this motor-driven pump is the ideal choice for professional and volunteer firefighters, or industrial firefighters looking for reliable, efficient equipment for their operations.



FEATURES

ENGINE	EFP-1000-10-B
ENGINE REFERENCE	Briggs & stratton 40CV
FUEL	fuel
STARTER	Push button
FUEL TANK	17 L
POWER	30,2 kW / 3 600 RPM
PUMP	
MAX FLOW RATE	1480 l/min
PERFORMANCES	1020 l/min at 10 bar
DIAM SUCTION	4" 1/2 male
DIAM DISCHARGE	2 X 2" 1/2 male
SUCTION HEIGHT	7 m
PRIMING	Automatic
DIMENSIONS	78,2 x 61,5 x 77,5 cm
WEIGHT	133 Kg



PRESSURE
Up to 15,5 bar



PUMP FLOW RATE
Up to 1480 l/min



WATER COMPATIBILITY
Seawater

PORTABLE BACKPACK PUMP FOR FOREST FIRES

EFP-FF-288/21

The lightest motor pump on the market. Specially designed for use in forest fires.

Lightweight and easily transportable with a backpack provided.

A backpack for accessories is also available.



FEATURES

ENGINE	
ENGINE	2 Times
FUEL	Mix 2 cycles
STARTER	Manual and electric by power bank
FUEL TANK	Separated 12 or 24L
POWER	10 Hp
POMPE	
MAX FLOW RATE	288 l/min
MAX PRESSURE	22 bar
PUMP TYPE	Turbine pump
PUMP BODY AND TURBINE	Hard alu
DIMENSIONS	39 X 29 X 17 cm
WEIGHT	12 Kg



PRESSURE
Up to 22 bar



PUMP FLOW RATE
up to 288 l/min



02

FLOATING MOTOR PUMPS

Our floating pumps are intended for pumping water from flooded areas, streams, ponds and available water sources.

AQUAFLOAT floating pump range.

With 2 or 4 stroke engines, EUROMAST gives you a complete choice of floating motor pumps for exhaustion or fire.





FLOATING MOTOR PUMP 1250 L/MIN ELECTRIC START

EFP-1250-FL-De



FEATURES

ENGINE

ENGINE REFERENCE	Briggs & Stratton (série 950)
FUEL	Gasoline
STARTER	Electric (power bank) and manual as backup
FUEL TANK	3.8 L
POWER	4.1 kW / 5.1 Kw

PUMP

MAX FLOW RATE	1258 l/min
PERFORMANCES	372 l/min at 3 bar 641 l/min at 2 bar
DIAM DISCHARGE	2"1/2 male
PUMP BODY AND TURBINE	Aluminum
FLOTTEUR	Durable polyethylene
DIMENSIONS	71 X 61 X 38 cm
WEIGHT	26.5 KG



PRESSURE
Up to 4.4 bar



PUMP FLOW RATE
Up to 1258 l/min

FLOATING MOTOR PUMP 1309 L/MIN

EFP-1300-32-FL



FEATURES

ENGINE

ENGINE REFERENCE	Briggs & stratton (850 series)
FUEL	Gasoline
STARTER	Manual
FUEL TANK	3.8 L
POWER	5.5 hp / 4.1 Kw

PUMP

MAX FLOW RATE	1309 l/min
PERFORMANCES	70 l/min at 3 bar 407 l/min at 2 bar
DIAM DISCHARGE	2"1/2 male
PUMP BODY AND TURBINE	Aluminum
FLOTTEUR	Polyethylene
DIMENSIONS	71 X 61 X 40 cm
WEIGHT	24.4 KG



PRESSURE
Up to 3 bar



PUMP FLOW RATE
Up to 1309 l/min

FLOATING MOTOR PUMP 480 L/MIN

EFE-FF-CIT-ST



FEATURES

ENGINE

ENGINE REFERENCE	2 times
FUEL	Gasoline
STARTER	Manual + Electric (optional)
FUEL TANK	5 L
POWER	8 hp / 6.1 Kw

PUMP

MAX FLOW RATE	480 l/min
PERFORMANCES	327 l/min at 4 bar
	151 l/min at 7 bar
	21 l/min at 9.5 bar
DIAM DISCHARGE	2" male
PUMP BODY AND TURBINE	Aluminum
FLOAT	Polyethylene
DIMENSIONS	83 X 51.5 X 42.5 cm
WEIGHT	21.2 KG



PRESSURE
Up to 9.5 bar



PUMP FLOW RATE
Up to 480 l/min

FLOATING MOTOR PUMP 1540 L/MIN

EFP-1500-2H-FL



FEATURES

EFP-1500-FL

ENGINE REFERENCE	Honda GXV 390
FUEL	Gasoline
STARTER	Manual
FUEL TANK	2.1 L
POWER	10 hp / 7.6 Kw

PUMP

MAX FLOW RATE	1540 l/min
PERFORMANCES	315 l/min at 4.5 bar
	610 l/min at 3 bar
	870 l/min at 2 bar
DIAM DISCHARGE	2"1/2 male
PUMP BODY AND TURBINE	Aluminum
FLOAT	Polyethylene
DIMENSIONS	103 X 73 X 50 cm
WEIGHT	53 KG



PRESSURE
Up to 5.5 bar



PUMP FLOW RATE
Up to 1540 l/min



FLOATING MOTOR PUMP 2512 L/MIN

EFP-2400-FL



FEATURES

ENGINE

ENGINE REFERENCE	Honda GXV 390
FUEL	Gasoline
STARTER	Manual
FUEL TANK	2.1 L
POWER	10 hp / 7.6 kw

PUMP

MAX FLOW RATE	2512 l/min
PERFORMANCES	1872 l/min at 1 bar
	932 l/min at 2 bar
	30 l/min at 2.4 bar
DIAM DISCHARGE	4" male
PUMP BODY AND TURBINE	Aluminum
FLOAT	Polyethylene
DIMENSIONS	98 X 71 X 50 cm
WEIGHT	56 KG



PRESSURE
Up to 2.4 bar



PUMP FLOW RATE
Up to 2512 l/min

PORTABLE TANK 2000 L

EFP-CITERNE-2000

Portable water storage tank with stents

Good wear resistance, high tear resistance, high strength and long service life.



FEATURES

MATTER	PVC coated fabric 980g/m2
MATERIAL THICKNESS	0,8 mm
DESIGN	Open top
KIND	Self-supporting
ASSEMBLY TIME	< 5 minutes
RESISTANCE TO BREAKAGE	> 2500 N/cm
APPLICABLE TEMPERATURE	20 °c to 70 °c



03

MOTORPUMPS

Construction site drainage pumps can be either submersible or surface-mounted. They efficiently circulate both clear and muddy water. Sump pumps are commonly used for draining water from construction sites and excavations. They are also well-suited for civil or industrial applications, such as surface drying.

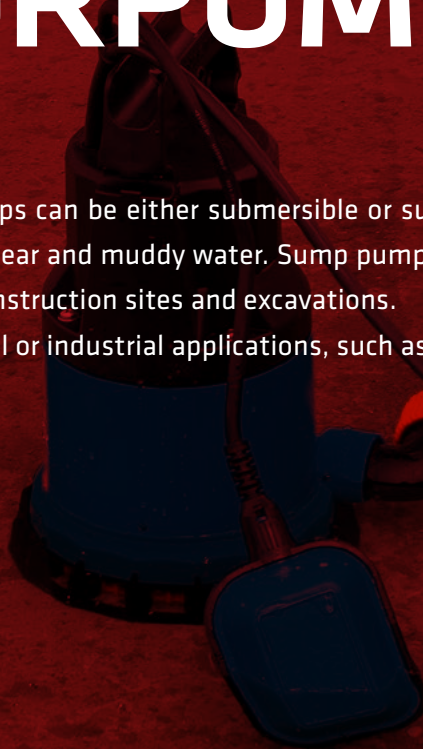



SMB SUBMERSIBLE DRAINAGE PUMP

EFP-SDP-800

Portable submersible electric pumps with automatic operation and high efficiency, ideal for continuous use even with low water levels. The NBR NBR-protected hydraulic part ensures greater resistance to corrosion. The small outside diameter enables it to be used in 8" wells. Used for draining seepage water, emptying flooded rooms or tanks, draining clean or slightly dirty wastewater.



CARACTÉRISTIQUES

MOTEUR

TENSION	Single phase 230V-50Hz (with float)
RATED POWER	0,75 kW
AMPERAGE	5
INSULATION CLASS	F
PROTECTION	IP68

POMPE

MAX FLOW	18 m ³ /h
HMT MAX	15,5
BODY	Aluminium die-casting
MECHANICAL SEAL	Double mechanical seal in oil chamber : Ceramic Graphite/NBR Silicon/Silicon/NBR
CABLE	10 mt H07RNF
DIMENSIONS	16,3 X 18,7 X 36,8 cm - H1 : 33,6cm - DNM : 2"
WEIGHT	16 KG



MAX FLOW RATE

Up to 18 m³/h



TYPES OF WATER

Slightly dirty wastewater.

SUBMERSIBLE DRAINAGE PUMP

EFE-370TSM



The pumps in the EFE-370TS(M) series are single-phase submersible pumps, compact, high-performance, and durable, designed for handling abrasive liquids on challenging construction sites, including mines, industries, public services, and construction projects.

The pump body and parts in contact with water are made of cast iron. Depending on the size, the pumps are equipped with a semi-open impeller made from high-strength stainless steel or ductile iron alloy.

Efficient cooling of the motor is achieved via a discharge channel integrated into the motor housing. Discharge outlets range from 50 mm to 80 mm. Motor power ranges from 0.25 kW to 1.5 kW. The hermetically sealed motors are equipped with an integrated thermal protection system.

Technical Specifications:

- Maximum Capacity: 42 m³/h
- Power: 0.25 kW to 1.5 kW
- Power Supply: Single-phase 230V \pm 10%, 50 Hz
- Insulation Class: F
- Protection Rating: IP68
- Cable Length: 10 m
- Water Temperature: Up to 40°C
- Maximum Water Depth: 25 m



Download the catalog for our full range of electric pumps with agitators
by scanning the QR code

DIESEL WATER DEPLETION PUMP

EFP-W30D



FEATURES

ENGINE

ENGINE REFERENCE	178 F
FUEL	Diesel
STARTER	Manual + Electric (optional)
FUEL TANK	14 L
POWER	7 hp / 9.5 Kw
AUTONOMY	2 hours approximately

PUMP

MAX FLOW RATE	50 m3/h
MAX PRESSURE	26 m
DIAM SUCTION	3" male
DIAM DISCHARGE	3" male
SOLID PASSAGE	35 mm
TYPES OF WATER	Loaded waters
DIMENSIONS	57 X 47 X 67,5 cm
WEIGHT	62 KG



MAX FLOW RATE
Up to 50 m3/h



TYPES OF WATER
Loaded waters

HOME PROTECTION EXHAUST MOTOR PUMP

EFP-W20D



FEATURES

ENGINE

ENGINE REFERENCE	4 Time
FUEL	Gasoline
STARTER	Manual
FUEL TANK	3.6 L
POWER	4.8 hp / 6.5 Kw

PUMP

MAX FLOW RATE	30m3/h
MAX PRESSURE	30 m
DIAM SUCTION	2" male
DIAM DISCHARGE	2" male
PUMP BODY AND TURBINE	Alu
SOLID PASSAGE	10 mm
TYPES OF WATER	Used
DIMENSIONS	50 X 38.5 X 41 cm
WEIGHT	23 KG



MAX FLOW RATE
Up to 30 m3/h



TYPES OF WATER
Waste water



GASOLINE EXHAUST MOTOR PUMP

EFP-120-3



FEATURES

ENGINE

ENGINE REFERENCE	Honda GX390
FUEL	Gasoline
STARTER	Manual
FUEL TANK	6.1 L
POWER	10.8 hp / 8.7 Kw
AUTONOMY	2 Hours

PUMP

MAX FLOW RATE	123 m3/h
MAX PRESSURE	30 bar-30 m
DIAM SUCTION	4" male
DIAM DISCHARGE	4" male
PUMP BODY AND TURBINE	Alu
SOLID PASSAGE	27 mm
TYPES OF WATER	Loaded waters
DIMENSIONS	78,5 X 56,5 X 63 cm
WEIGHT	85 KG



MAX FLOW RATE

Up to 123 m3/h



TYPES OF WATER

Eaux chargées

SUMP PUMP RESISTANT TO CHEMICALS AND SEAWATER

EFP-30-5-AGRI



FEATURES

ENGINE

ENGINE REFERENCE	Honda GX120 4 stroke
FUEL	Gasoline
STARTER	Manual
FUEL TANK	6.5 L
POWER	2.6 KW / 3600 rpm
AUTONOMY	4 Hours

PUMP

MAX FLOW RATE	33.5 m3/h
MAX PRESSURE	26 m
DIAM SUCTION	2" Female
DIAM	2" Female
PUMP BODY AND TURBINE	PVC
SOLID PASSAGE	10 mm
TYPES OF WATER	Wastewater and Seawater, chemical
DIMENSIONS	51 X 41,8 X 43,3 cm
WEIGHT	22 KG



MAX FLOW RATE

Up to 33.5 m3/h



TYPES OF WATER

Wastewater and seawater, chemical

MOTOR PUMP FOR EXHAUSTING VERY CHARGED WATER

EFP-900-2-D

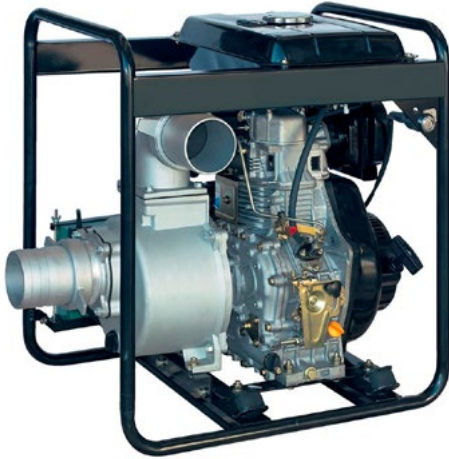

FEATURES

ENGINE

ENGINE REFERENCE	198 F
FUEL	Diesel
STARTER	Electric + Manual
FUEL TANK	12.5 L
POWER	9.6 hp / 6.7 Kw
AUTONOMY	4 Hours

PUMP

MAX FLOW RATE	96 m3/h
MAX PRESSURE	31 m
DIAM SUCTION	4" male
DIAM DISCHARGE	4" male
PUMP BODY AND TURBINE	Alu
SOLIDE PASSAGE	10 mm
TYPES OF WATER	Waste water
DIMENSIONS	67 X 50,5 X 74 cm
WEIGHT	87 KG



MAX FLOW RATE
Up to 96 m3/h



TYPES OF WATER
Waste water

MOTOR PUMP FOR EXHAUSTING VERY CHARGED WATER

EFP-51-3-EL / EFP-51-3-H / EFP-51-3-D



FEATURES

ENGINE	ELECTRIC	GASOLINE	DIESEL
ENGINE REFERENCE	230/400V three-phase	Honda GX160QX	Kholer KD15350 Yanmar L48
STARTER	Electric + manual or manual (except Electric)		
TUBULAR CHASSIS	Handles with wheels optionon		
FUEL TANK	Depending on engine		
POWER	2.7 hp / 2.2 Kw		
AUTONOMY	2 Hours		
PUMP			
MAX FLOW RATE	51 m3/h		
MAX PRESSURE	30 m		
DIAM SUCTION	2'' male		
DIAM DISCHARGE	2'' male		
PUMP BODY	and Turbine : Cast iron		
PASSAGE DE SOLIDE	28 mm		
TYPES OF WATER	Dirty water + Seawater (optional)		
DIMENSIONS	77,5 X 44 X 59 cm		
WEIGHT	30 KG		



MAX FLOW RATE
Up to 51 m3/h



TYPES OF WATER
Dirty water and seawater (optional)



MOTOR PUMP FOR EXHAUSTING VERY CHARGED WATER

EFP-100-2.8-EL / EFP-100-2.8-H / EFP-100-2.8-D



FEATURES

ENGINE	ELECTRIC	GASOLINE	DIESEL
ENGINE REFERENCE	230/400V three-phase	Honda - Robin Briggs - Lombardini	Hatz Lombardini
STARTER	Electric + manual or manual (except Electric)		
CHASSIS TUBULAIRE	Handles with wheels optionon		
FUEL TANK	Depending on engine		
POWER	10.8 hp / 8.7 Kw		
AUTONOMY	2 Hours		
PUMP			
MAX FLOW RATE	100 m3/h ; Electric motor : 1800t		
MAX PRESSURE	28 m		
DIAM SUCTION	3'' male		
DIAM DISCHARGE	3'' male		
PUMP BODY AND TURBINE	Font		
SOLID PASSAGE	38 mm		
TYPES OF WATER	Dirty water + Seawater optional		
DIMENSIONS	86 X 58 X 63 cm		
WEIGHT	52 KG		



MAX FLOW RATE

Up to 100 m3/h



TYPES OF WATER

Dirty water and seawater (optional)

MOTOR PUMP FOR EXHAUSTING VERY CHARGED WATER

EFP-144-3-EL / EFP 143-3 / EFP-144-3-D



FEATURES

ENGINE	ELECTRIC	GASOLINE	DIESEL
ENGINE REFERENCE	230/400V three-phase	Honda - Robin Briggs - Lombardini	Hatz Lombardini
STARTER	Electric + manual or manual (except Electric)		
CHASSIS TUBULAIRE	Handles with wheels option		
FUEL TANK	Frompending on engine		
POWER	10.8 hp / 8.7 Kw		
AUTONOMY	2 Hours		
PUMP			
MAX FLOW RATE	144m3/h		
MAX PRESSURE	32 m		
DIAM SUCTION	FM 4'' male		
DIAM DISCHARGE	FM 4'' male		
PUMP BODY AND TURBINE	Font		
SOLID PASSAGE	40 mm		
TYPES OF WATER	Dirty water + Seawater (optional)		
DIMENSIONS	86 X 58 X 63 cm		
WEIGHT	70 KG		



MAX FLOW RATE

Up to 144 m3/h



TYPES OF WATER

Dirty water and seawater (optional)

04

COLONNE
SECHE

Parking

Théâtre

MOTOR PUMPS TO TEST DRY COLUMN

Test pump for checking dry columns under static pressure.

Test your dry columns easily with our test pumps. When a fire occurs, it is imperative that the water columns are functional and comply with standard NF S 61-759 «Installation and maintenance of dry and loaded columns» in order to detect a possible leak or failure on a component part, and for this it is mandatory to carry out hydrostatic tests (Pressurization at 16/25B).





THERMAL TEST PUMP FOR DRY GASOLINE COLUMNS

EFP-25-0.8B - STATIC TEST



FEATURES

ENGINE

ENGINE REFERENCE	Honda GP160 -4Hp
FUEL	Gasoline
STARTER	Manual
FUEL TANK	31 L
POWER	4 hp / 3 Kw

PUMP

MAX FLOW RATE	25 l/min
MAX PRESSURE	25 bar
PUMP TYPE	Diaphragm pump
PUMP BODY AND TURBINE	Aluminum
DIMENSIONS	67 X 45 X 46 cm
WEIGHT	36 Kg



PRESSURE
Up to 25 bar



PUMP FLOW RATE
Constant 25 l/min

ELECTRIC TEST PUMP FOR DRY COLUMNS

EFP-25-0.8-B-E - STATIC TEST



FEATURES

ENGINE

STARTER	Electric
POWER	Single phase 240 V/Hz

PUMP

MAX FLOW RATE	25 l/min
MAX PRESSURE	25 bar
PUMP TYPE	Diaphragm pump
PUMP BODY AND TURBINE	Aluminum
DIMENSIONS	67 X 45 X 46 cm
WEIGHT	33 Kg



PRESSURE
Up to 25 bar



PUMP FLOW RATE
Constant 25 l/min

TEST PUMP KIT FOR STATIC DRY COLUMNS WITH
TANK FOR PICK-UP OR TRAILER

EFP-KIT-PUMP



FEATURES	ENGINE	ELECTRIC	GASOLINE
	ENGINE REFERENCE	EFP-25-0.8-BE	EFP-25-0.8-B-
	STARTER	Manual	
	POWER	4 hp / 3 Kw Single phase 240 V/Hz	
	PUMP		
	MAX FLOW RATE	25 l/min	
	MAX PRESSURE	25 bar	
	PUMP TYPE	Diaphragm pump	
	PUMP BODY AND TURBINE	Aluminum	
	DIMENSIONS	147 X 100 X 67,9 cm	
	WEIGHT	200 KG	



PRESSURE
Up to 25 bar



PUMP FLOW RATE
Constant 25 l/min



SHAPED TANKS
Cube (2500 l max), T or L shape (600 l max)

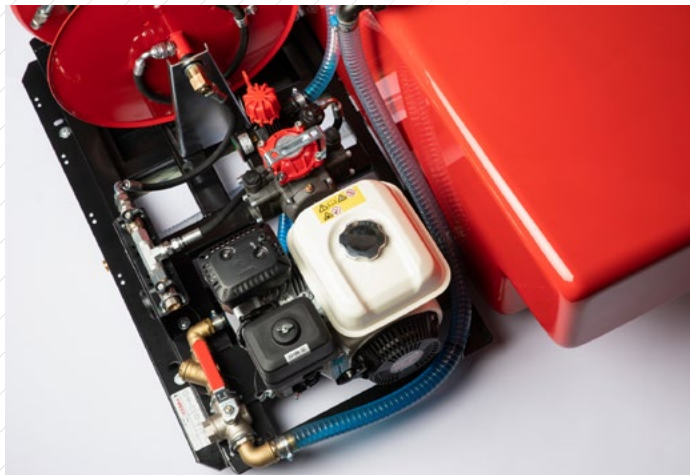
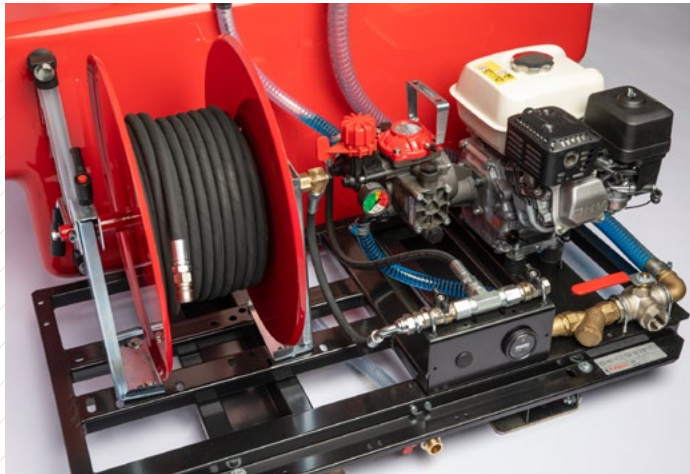



DYNAMIC THERMAL TEST PUMP KIT FOR DRY OR FIRE COLUMNS, CHEMICAL PRODUCTS, AND SEAWATER

EFP-1500-10 - DYNAMIC TEST



FEATURES

ENGINE

ENGINE REFERENCE	FPT 1368
FUEL	Gasoline
STARTER	Electric + Manual
FUEL TANK	18 L
POWER	77 hp / 57 Kw

PUMP

MAX FLOW RATE	2400 l/min
PERFORMANCES	1500 l/min at 10 bar 800 l/min at 8 bar
DIAM SUCTION	4" 1/2 male
DIAM DISCHARGE	2 X 2" 1/2 male
PUMP BODY AND TURBINE	Aluminum alloy in marine grade
PRIMING	Automatic
DIMENSIONS	110,9 X 74 X 84 cm
WEIGHT	195 Kg



PRESSURE
Up to 16 bar



PUMP FLOW RATE
Up to 2400 l/min



SHAPED TANKS
Cube (2500 l max), T or L shape (600 l max)



05

HIGH-PRESSURE FIRE-FIGHTING KITS

Fire extinguisher kit to be placed on an emergency vehicle (quad, pick-up, van or trailer) with high or low pressure motor pump.

Autonomous and compact fire-fighting equipment for immediate action.

The vaporized water makes it possible to increase the heat exchange area and to absorb a greater amount of heat and thus obtain a greater cooling capacity.

Fire kits are formidable tools against fire as first aid equipment.

They are ideal on small vehicles, where larger ones cannot pass.





Fireco high-pressure kits provide a modern, mobile and sustainable response to fires, with compact equipment, reduced water consumption, maximum thermal and physical efficiency, and rapid intervention capacity even in the most complex areas.

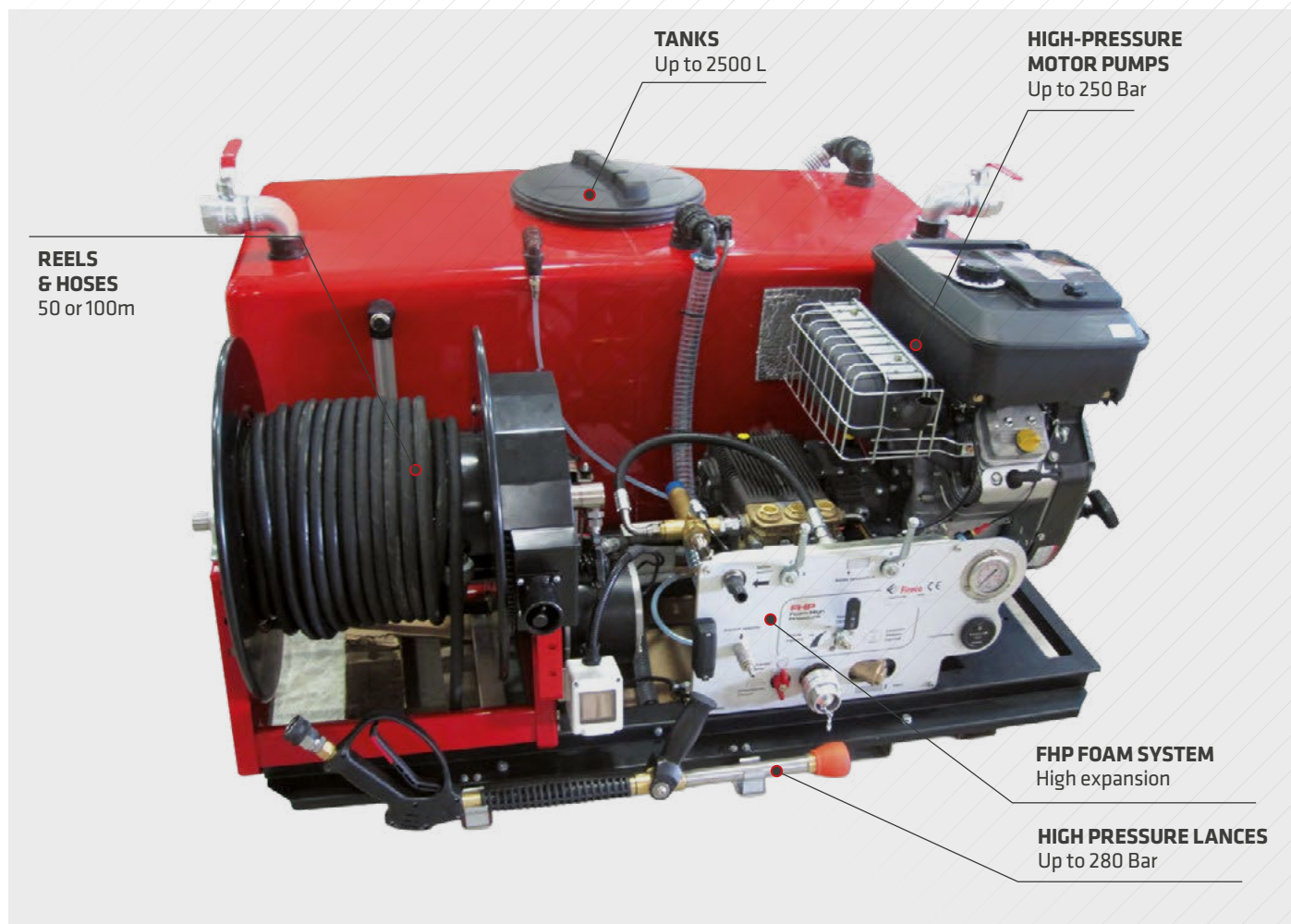

THE ADVANTAGES OF HIGH PRESSURE SYSTEMS

- | | | | |
|----------|---|----------|---|
| 1 | Significant reduction in water consumption | 2 | Extended scope of intervention |
| 3 | Increased thermal efficiency | 4 | Natural asphyxiant action |
| 5 | Physical impact of micro-droplets | 6 | Reduction of the critical flow requirement (CFR) |



FIRE FIGHTING KITS

MOTOR PUMPS + TANKS + REELS + HIGH PRESSURE NOZZLES

The fire kits are equipped with a T - C - L shaped tank

The choice of tank shape and capacity is most often determined by the carrier vehicle.

We also offer a wide choice of flow rate/pressure ranging from 50L/min 40 bar to 21L/min 250 bar.

Petrol or diesel engine, we also offer an optional FHP foam sytem Custom-made,

All our kits are assembled and can be customized on demand.

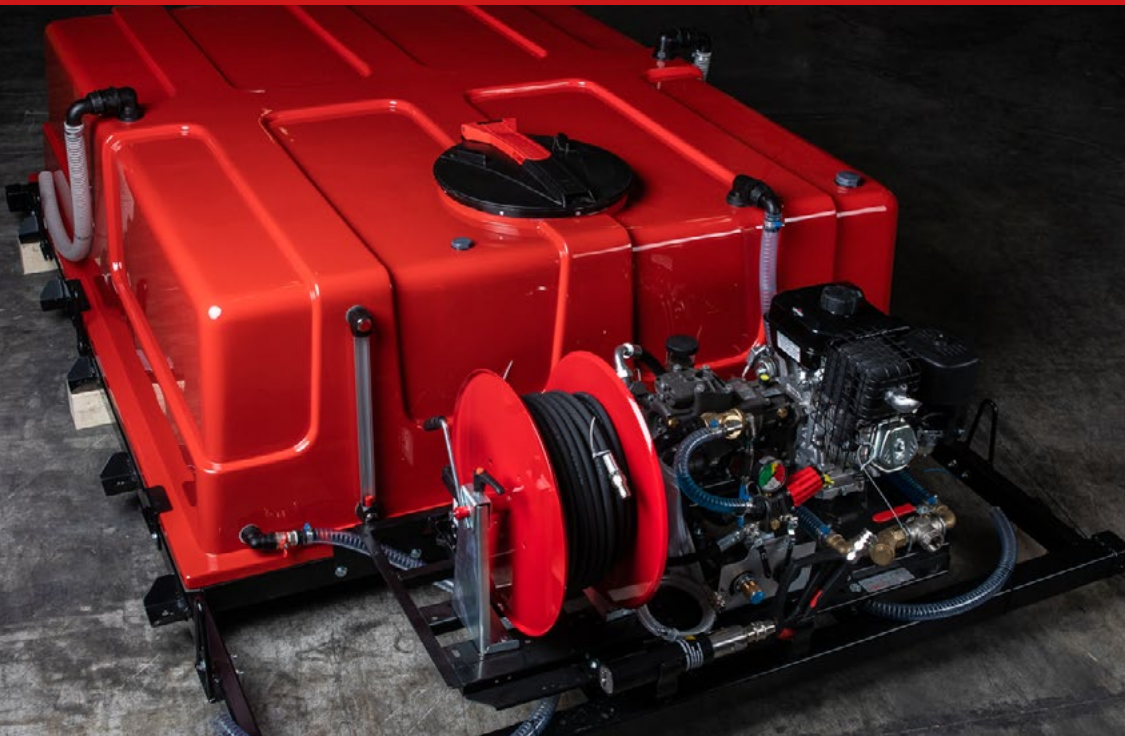

Système qualité



Examples of uses

Quad



Trailer



Pick-up



- **50 bar diaphragm pumps:** For forest or urban use, with water or foam. class A fire
- **100 bar piston pumps:** They are appreciated for their versatility by forest brigades, professional firefighters, civil protection, for urban or rural fires with water or foam, class A fire .
- **Piston pumps from 150 to 250 bar :** Used by forest brigades, professional firefighters, civil protection, for urban or rural area fires, and are used mainly for urban areas for class A fire, chemical fires and airports, with water or foam.



CONFIGURATION TABLE

Define your fire kit request

1 - CHOOSE THE TANK

☐ Fiber tank



☐ Steel tank



☐ "T" shaped tank
Capacity from 350 L to 600 L



☐ Cubic tank "C"
Capacity from 100 L to 2500 L



☐ "L" shaped tank
Capacity from 350 L to 600 L



☐ Tank for quad "Q"
Capacity from 100 L to 200 L



Desired capacity: L

2 - CHOOSE THE MOTOR PUMP

Diaphragm pump

☐ Gasoline engine

50 L/min - 40 Bar

70 L/min - 40 Bar

80 L/min - 50 Bar

100 L/min - 50 Bar

135 L/min - 20 Bar

☐ Diesel engine

50 L/min - 40 Bar

70 L/min - 40 Bar

80 L/min - 50 Bar

100 L/min - 50 Bar

135 L/min - 20 Bar

Piston pump

☐ Gasoline engine

42 L/min - 100 Bar

42 L/min - 150 Bar

34 L/min - 170 Bar

50 L/min - 100 Bar

21 L/min - 180 Bar

21 L/min - 250 Bar

21 L/min - 200 Bar

☐ Diesel engine

42 L/min - 100 Bar

42 L/min - 150 Bar

34 L/min - 170 Bar

21 L/min - 200 Bar

3 - CHOOSE THE TYPE OF REEL

☐ Manual fixed reel



☐ Steel reel
transportable



☐ Electric fixed reel



Desired pipe length:

☐ 50 m

☐ 100 m

☐ Other :

4 - CHOOSE THE DESIRED ACCESSORIES

☐ FHP foam system option

Our patented FHP system allows the operator to achieve the best performance even with 200 m of hose, while maintaining the correct mixture between water and foam.



☐ High pressure lance
Water



☐ High pressure lance
Water/Foam



☐ Hydro-éjecteur
remplissage citerne



☐ Automatic accelerator

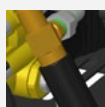

☐ Quick fix guide for the
kit on a vehicle tray

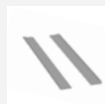

OG



FLOOD TRAILERS

The patented multifunctional pumping unit can be used simultaneously as **generator**, **lighting mast** and pump with the possibility of doing **vary flow rates** and pressures thanks to an inverter. It guarantees water evacuation with flow rates of **100 to 500 m³/h**.

The **generator set**, supplied as standard in SUPER SILENT version, is available with a power supply from 10 to 200 kVA.

It is completed by a **LED lighting telescopic mast**.

Highly customizable equipment that improves end-user interventions.





FIREFIGHTER INTERVENTION TRAILER **PERFORMANCE AND RELIABILITY AT A NEW LEVEL**



PUMPING SYSTEM
Efficient and reliable
Self-priming with
high solids passage

CONTROL PANEL
Simple

ACCESSORIES INCLUDED
4 x 2m suction hoses 25m
discharge hose Suction
strainer
Spare wheel

CONFIGURATION
Soundproof or not

ROAD TRAILER
For rapid intervention



TECHNICAL SPECIFICATIONS



HMT
From 18 to 48m



RATES
From 150 at 900 m³/h



SOLID PASSAGE
From 50 to 76 mm



SUCTION DEPTH
Up to 8 meters



COMBINED FLOOD/FIRE RESPONSE TRAILER THE MULTIFUNCTIONAL RESPONSE TO THE MOST DEMANDING SITUATIONS.





FIREFIGHTER RESPONSE TRAILER FLOOD / FIRE

**Highly effective in combating critical
Problems and flood emergency situations.**

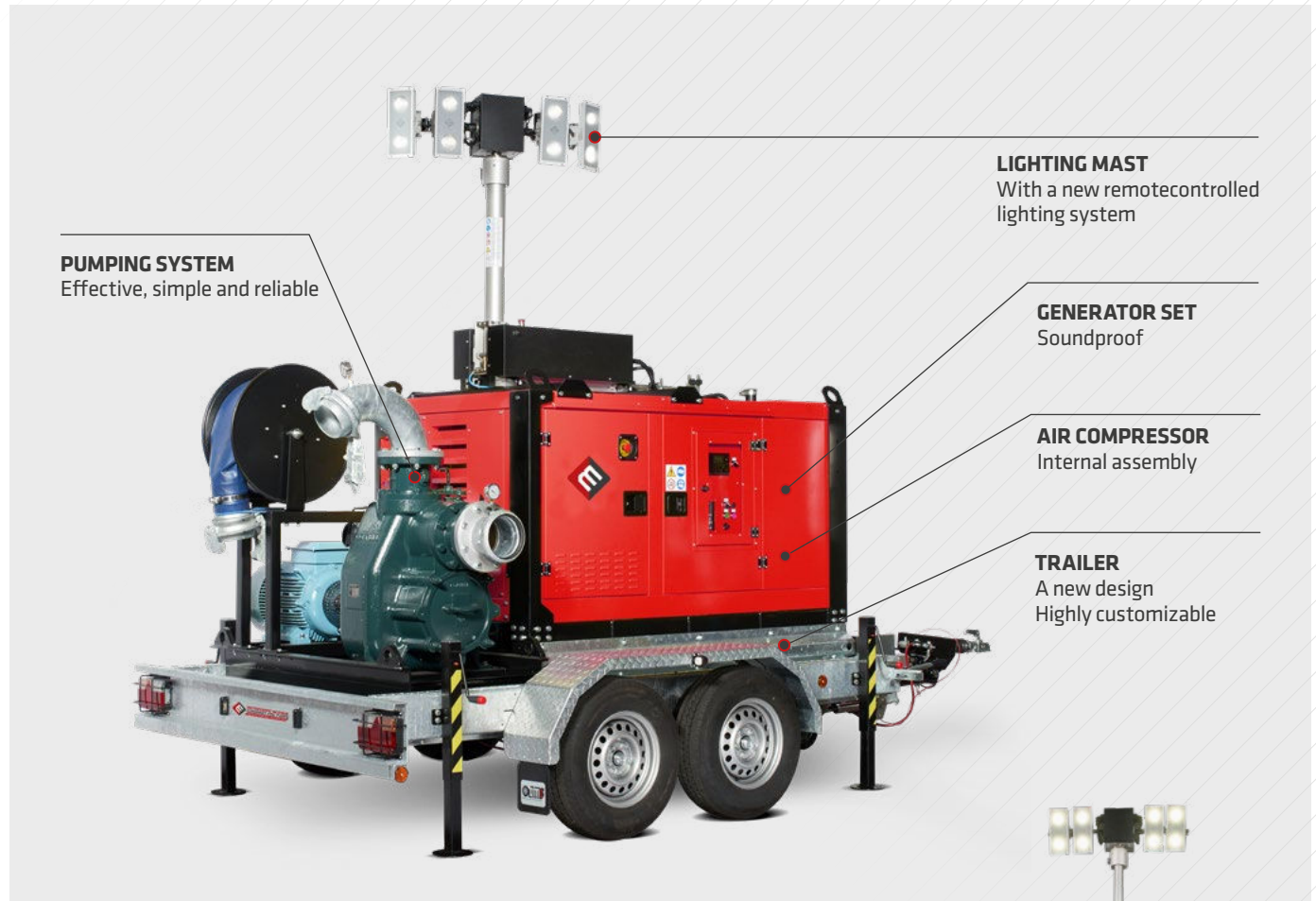

PUMPING SYSTEM
Effective, simple and reliable

LIGHTING MAST
With a new remotecontrolled
lighting system

GENERATOR SET
Soundproof

AIR COMPRESSOR
Internal assembly

TRAILER
A new design
Highly customizable

TECHNICAL SPECIFICATIONS



PRESSURE
From 2 at 16 bar



RATES
From 100 to 500 m³/h



GENERATOR
From 10 to 200 kVA



RESIDUAL POWER
From 10 to 200 kVA



SUCTION DIAMETER
From 100 mm (4")



SUCTION DEPTH
Up to 8 meters



FLOOD EMERGENCY PUMPS. CUSTOMIZED SOLUTION FOR ANY TYPE OF NEED.

High-performance diesel engine pump units, adaptable to each type of need, with flow rates from 30 to 1450 m³/h with **variable pressures**. Each model can be specially designed and manufactured according to the specific requirements of the customer. Available in several ranges : **FIXED, TOWABLE, SILENT...**



TECHNICAL SPECIFICATIONS



PRESSURE
Up to 16 bar



PUMP FLOW RATE
Up to 1450 m³/h



MAX SOLIDS
3" (76 mm)



DISCHARGE FLANGE
DN80 at DN300 - 3" at 12"

APPLICATIONS

- ✓ Flood zone management
- ✓ Firefighting support Bypass
- ✓ Pumping
- ✓ Water transfer
- ✓ Control of the level of rivers, lakes, or bodies of water



CONFIGURATION TABLE

Configure your custom pump in just a few steps

ENERGY

☐ Diesel engine ☐ Gasoline engine ☐ Electric engine

PUMP OUTPUT PERFORMANCE



PUMP FLOW RATE

.....m³/h



PRESSURE

.....bar



WATER TYPE

☐ Clear water ☐ Charged water ☐ Salt water ☐ Others



CONTROL PANEL

☐ Simple ☐ From a distance

PRIMING SYSTEM



☐ Hand pump



☐ Primer tray



☐ Electric pump manual



☐ Electric Self Priming

VERSION	A	B	C	D	E
	 FIXED	 FORKLIFT	 LIFTING HOOK	 SLOW TRAILER	 ROAD TRAILER
CONFIGURATION	1	2	3	4	5
	 ALL OPEN	 PROTECTIVE ROOF	 SIDE PROTECTIONS	 SILENT	 SUPER SILENT



07

HAND FIRE NOZZLES

EUROJET fire nozzles are available in two ranges: selection flow (manually adjustable flow) or automatic flow (automatic adjustment flow to maintain constant pressure and distance jet). EUROFOAM foam adapters can be added to our nozzles to enable the use of emulsifier.

Euromast always puts the needs of its customers first by improving existing products to meet the most demanding situations.





Main features

- Manual flow adjustment with 4 to 5 different positions. *Adjustable from straight*
- Jet to diffused jet, up to screen jet
- Ergonomic handle for a good grip
- Optional foam adapter



Manual
Adjustable flow rate



AUTOMATIC
Automatic adjustable flow rate

Nozzle adjustment

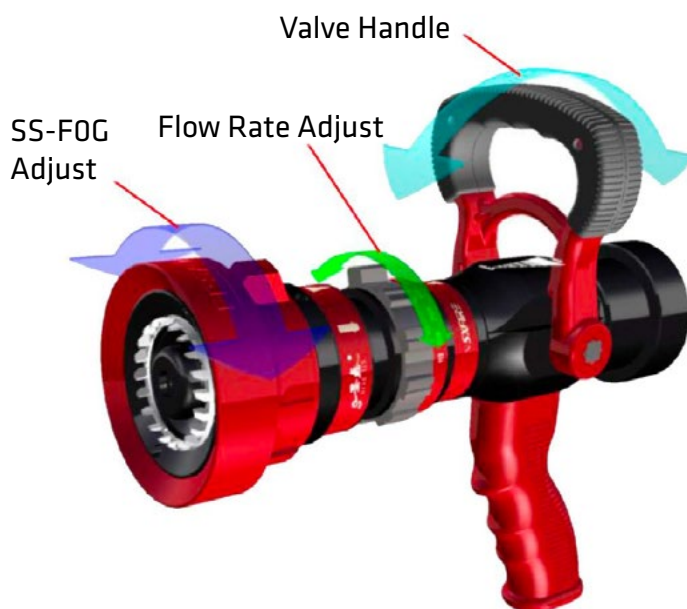

Straight Stream



Narrow Fog

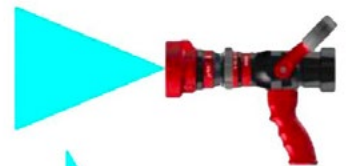

Wide Fog



VARIABLE FLOW NOZZLE 150 L/MIN

EUROJET-150



VARIABLE FLOW NOZZLE 235 L/MIN

EUROJET-235



FEATURES

EFE-EUROJET-150

VARIABLE FLOW	19-38-95-150 lpm/purge
FLOW CONTROLE	Rotating ring
MAXIMUM RANGE	25m at 6 bar
MATERIALS	Hard anodized aluminum (body); molded nylon (handle); rubber (head bumper)
VALVE	Ball valve
VALVE MATERIALS	ABS, Aluminum
MAX ANGLE OF DIFFUSED JET	From straight Jet to 110° jet
DIMENSIONS	230 x 122 x 294mm
WEIGHT	1.8 kg
ACCESSORIES	Foam tube (optional)



INLET
DIAMETER 1"



FLOW RATE
Up to 150 LPM

FEATURES

EFE-EUROJET-235

VARIABLE FLOW	60-130-235 lpm/purge
FLOW CONTROLE	Rotating ring
MAXIMUM RANGE	35m at 7 bar
MATERIALS	Hard anodized aluminum (body); molded nylon (handle); rubber (head bumper)
VALVE	Ball valve
VALVE MATERIALS	ABS, Aluminum
MAX ANGLE OF DIFFUSED JET	From straight Jet to 110° jet
DIMENSIONS	230 x 122 x 294mm
WEIGHT	1.8 kg
ACCESSORIES	Foam tube (optional)



INLET
Diameter 1"



FLOW RATE
Up to 235 LPM

VARIABLE FLOW NOZZLE 500 L/MIN

EUROJET-500



VARIABLE FLOW NOZZLE 1000 L/MIN

EUROJET-1000



FEATURES

EFE-EUROJET-500

VARIABLE FLOW	110-230-360-500 lpm/purge
FLOW CONTROLE	Rotating ring
MAXIMUM RANGE	40m at 7 bar
MATERIALS	Hard anodized aluminum (body); molded nylon (handle); rubber (head bumper)
VALVE	Ball valve
VALVE MATERIALS	ABS, Aluminum
MAX ANGLE OF DIFFUSED JET	From straight Jet to 110° jet
DIMENSIONS	280 x 345 x 120 mm
WEIGHT	2.1kg
ACCESSORIES	Foam tube (optional)



INLET
Diameter 1,5"



FLOW RATE
Up to 500 LPM

FEATURES

EFE-EUROJET-1000

VARIABLE FLOW	350-475-560-1000 lpm/purge
FLOW CONTROLE	Rotating ring
MAXIMUM RANGE	55m at 7 bar
MATERIALS	Hard anodized aluminum (body); molded nylon (handle); rubber (head bumper)
VALVE	Ball valve
VALVE MATERIALS	ABS, Aluminum
MAX ANGLE OF DIFFUSED JET	From straight Jet to 110° jet
DIMENSIONS	280 x 345 x 120 mm
WEIGHT	2.9 kg
ACCESSORIES	Foam tube (optional)



INLET
Diameter 2,5"



FLOW RATE
Up to 1000 LPM



AUTOMATIC DOUBLE JET PRESSURE REGULATED LANCE

EFE-EUROJETMATIC-500



FEATURES

EFE-EUROJETMATIC-500

DESCRIPTION	Automatic flow and adjustable jet
ENTRANCE AT RACCORD	1.5"
TURNING POINT	
AUTOMATIC FLOW RATE	50-500 L/min
FEATURES	Combination of a straight jet and diffused jet
MAXIMUM RANGE	50 m at 7 bar
MATERIALS	Anodized Aluminum (body), ABS (handle), rubber (bumper)
VALVE	Ball valve
VALVE MATERIALS	Stainless steel
MAX ANGLE DU OF DIFFUSED JET	From straight jet to 130° jet
DIMENSION	225 x 119 x 240mm ; 2.5 kg
WEIGHT	2,5 kg



INLET
1.5"



FLOW RATE
50-500 L/min



JET TYPE
Straight jet, diffused and mist

LANCE WITH DIFFUSER

DN40/DN65 lance barrel + DN40/DN65 diffuser



FEATURES

LANCE + DIFFUSEUR DN40

ENTRANCE	DN40
MATERIALS	Aluminum alloy
WEIGHT	1 Kg
DIFFUSION	Closed, sheet jet and straight jet
STANDARDS	NF S61-820

LANCE + DIFFUSEUR DN65

ENTRANCE	DN65
MATERIALS	Aluminum alloy
WEIGHT	1.8 Kg
DIFFUSION	Closed, sheet jet and straight jet
STANDARDS	NF S61-820



INLET
1,5" or 2,5"



JET TYPE
Sheet jet or straight jet

EUROFOAM FOAM TUBE

EFE-EUROFOAM-235 / EFE-EUROFOAM-500 / EFE-EUROFOAM-1000



FEATURES

EFE-EUROFOAM-235-1'

LENGTH	30.5 cm
WEIGHT	0.8 Kg
PROLIFERATION	5
MATERIALS	Hard anodized Aluminum

EUROFOAM-500-1.1/2

LENGTH	32 cm
WEIGHT	1.1 Kg
FOAMING	5
MATERIALS	Hard anodized Aluminum

EFE-EUROFOAM-1000-2.5"

LENGTH	33.5 cm
WEIGHT	1.4 Kg
FOAMING	5
MATERIALS	Hard anodized Aluminum

DOOR

FIRE HOSES

Fire hoses for fire fighting, we propose a complete range of fire hoses to intervene in the best conditions.

We distribute and market the products worldwide...





EUROFLEX FLATTNABLE FIRE HOSES

EUROFLEX - Exceptional Durability, Versatility, Reliability in Extreme Conditions, Ease of Use, Low Maintenance, Certified Performance, Adaptability, Maritime Use - International couplings, ask us for your standard



FEATURES	SIZES	RÉFÉRENCES
	DN110/20	EUROFLEX-R-AR100-20M-AL
	DN110/10	EUROFLEX-R-AR100-10M-AL
	DN70/40	EUROFLEX-R-DSP70-40M
	DN70/20	EUROFLEX-R-DSP70-20M
	DN45/40	EUROFLEX-R-DSP45-40M
	DN45/20	EUROFLEX-R-DSP45-20M
FEATURES	FEATURES	
	MATTER	Nitrile PVC
	RESISTANCE	Resists abrasion, hydrocarbons and chemicals, seawater
	USE	Exterior (withstands harsh weather conditions)
	INTERVIEW	None



STANDARDS

DIN 14811 classe 3 - BS6391 Type 3 - NFS 61112 - NFS 61112 - MED (Marine Equipment Directive)

FORESTFLEX FLATTNABLE FIRE HOSES

FORESTFLEX



FEATURES	SIZES	RÉFÉRENCES
	DN70/40	FORESTFLEX-J-DSP70-40M
	DN70/20	FORESTFLEX-J-DSP70-20M
	DN45/40	FORESTFLEX-J-DSP45-40M
	DN45/20	FORESTFLEX-J-DSP45-20M
	FEATURES	
	MATTER	Teflon
FEATURES	RESISTANCE	Abrasion resistant, seawater
	USE	Forest
	EXTERNAL WALL	Circular weaving in fluorescent yellow
	ENVELOPE	Double-weave polyester with double internal coating and EPDM



STANDARDS

DIN 14811 - EN 14540 - PREN 1924-1 - NFS 61112

FLEXIBLE SUCTION HOSES WITH AR FITTING

ALUMINUM OR BRONZE

EFE-TUYAU-ASPIRAL



FEATURES	TUYAU ASPIRAL	
	INTERNAL DIAMETER	100 mm
	EXTERNAL DIAMETER	128 mm
	THICKNESS	9 mm
	WORKING PRESSURE	10 bar
	CURVATURE RADIUS	890 mm
	WEIGHT	10 Kg
	INNER TUBE	Smooth SBR rubber
	REINFORCEMENT	4 textile plies and metal spirals
	RECOVERY	Abrasion and weather resistant SBR rubber
	PERMISSIBLE DEPRESSION	0.9 bar
	APPEARANCE	Cloth rubber
	LENGTH	2m



STANDARDS

NF ISO 14557 - NFS 61113 - AFNOR

SEMIFLEX-O-GFR20

TUYAU SEMI FLEX WITH OR WITHOUT FITTINGS



NORME
DIN - EN 1947

FEATURES

TUYAU SEMI FLEX

DIAMETER IN INCHES	1
DIAMETER	25 mm
BURST PRESSURE	95 bar
BURST PRESSURE (DIN)	45 bar
WORKING PRESSURE (DIN)	15 bar
CURVATURE RADIUS	140 mm
VOLUME FLOW RATE	l/min
WALL THICKNESS	2.8 mm
PERMISSIBLE DEPRESSION	0.9 bar
WEIGHT G/M	265
LENGTH	20 / 30 / 40 m
FITTINGS	GFR20 Male/Female

SEMI-RIGID HOSE

TAT0045



NORME
DIN - EN 1947 + A1 CLASSE 2 (Fabric reinforced plastic tube and coating)

FEATURES

SEMI-RIGID PIPE

INNER TUBE	Red PVC
REINFORCEMENT	1 textile braid
RECOVERY	PVC
PERMISSIBLE DEPRESSION	0.9 bar
APPEARANCE	Smooth
TEMPERATURE	-20°C to + 60°C
COLOR	Red or black
LENGTH	20, 30, 40 meters
HOSE 995 25 CATEGORY 1	
HOSE 996 25 CATEGORY 2	

RIGID PVC SPIRAL SUCTION HOSES

ASPI-PVC-DNXX



FEATURES

TUYAU ASPIRATION

SURFACE	Smooth
PIPE	Flexible
RESISTANCE	Abrasion, chemical and crush resistant
LENGTH	2m
PERFORMANCES	
TEMPERATURE RANGE	-5°C + 60°C
Ø INTERIOR	From 20 to 80 mm
WEIGHT	210 to 1450 g/m



STORAGE RACK

EFE-RACK

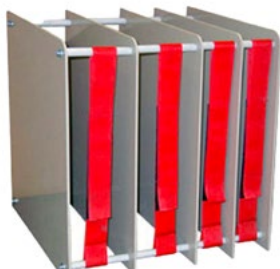

FEATURES

STORAGE RACK

- For vehicle trunk or trailer
- Flat hose storage for any diameters
- Customizable straps
- Quick to install
- Compact

ADDITIONAL INFORMATION

WEIGHT	Following the dimension of the rack
DIMENSIONS	Following the dimension of the rack

FIXED HOSE REELS

EFE-29317



FEATURES

FIXED REEL

HOSE DIAM	DN25-1"
WINDING	Right or left
PIPE CAPACITY	40 or 80 m
FLANGE DIAMETER	480 or 610 mm
WINDING	Top winding
WEIGHT	34 or 37 kg
COMPLIANT WITH STANDARD	NF S61-522

HIGH PRESSURE ELECTRIC FIXED HOSE REELS

Fixed reels with 12 or 24v electric motors including 50 to 100 m of steel braided reinforced rubber hose, quick connectors and electric rewind as standard.



FEATURES

FIXED REEL

HOSE DIAM	From 3/8 to 1"¼
ELECTRIC MOTORS	12-24 V and 220-380 V
HOSE CAPACITY	50 or 100 m
INPUT AND OUTPUT DIAMETERS	From 3/8 to 1"¼,
CONNECTION	Straight or 90° turning in brass or stainless steel
MAX PRESSURE	From 30 to 350 Bar
COMPLIANT WITH STANDARD	CE

MOBILE REELS

EFE-5602



FEATURES

MOBILE REELS

SUPPORT CONNECTOR	DSP65
WHEELS	Large unbreakable
CRUTCH	Stainless steel
ORDER	Wheel brake lock
VISIBILITY	Class 2 retro-reflective strips
WHEEL SHAFT	Stainless steel
ABILITY	200 m of DN70 flattable pipe
DIMENSIONS	Dimensions : 927 x 800 x 1310mm

09

KEYS, TAPS ACCESSORIES

Our range of fire-fighting faucets is designed to ensure quick and effective response in case of an emergency. With robust materials, high pressure resistance, and compliance with the most stringent safety standards, these devices are ideal for protecting your property and loved ones.

Easy to install and use, our products combine performance and durability for optimal safety.





DIVISION AT DEUX OR TROIS ROBINANDS

DIV-DSP65 DIV-DSP40



FEATURES

DIV-DSP65/2X40

DN ENTRY	DSP65
DN OUTPUT 1	DSP40
DN OUTPUT 2	DSP40
MATTER	Aluminum

DIV-DSP65/2X65

ENTRANCE	DSP65
DN OUTPUT 1	DSP65
DN OUTPUT 2	DSP65
MATTER	Aluminum

ADAPTATOR

RE-AR100-SYM65/RE-AR100-DSP65/RE-DSP65-DSP40 in Aluminum or bronze



FEATURES

ADAPTATOR

	RE-AR100-SYM65	RE-AR100-DSP65	RE-DSP65-DSP40
INLET DIAMETER	DN100	DN100	DN65
OUTPUT DIAMETER	DN 65	DN 65	DN 40
TYPE OF JOINT	Flat	To lip	To lip
MATTER	Aluminum or bronze	Aluminum or bronze	Aluminum or bronze

POST KEY

EFE-03033



FEATURES

POST KEY

MATTER	Aluminum alloy
2 FINGERS CYLINDRICAL	For unlocking the steering wheels
SQUARES	30x30 and 15x15
HOOK	For taps
WEIGHT	2 Kg
DIMENSIONS	618 x 80 x 280 cm

ARTICULATED KEY

EFE-02971



FEATURES

ARTICULATED KEY

MATERIALS	Aluminum alloy
SQUARES	30x30 and 15x15
HOOK	For cover
WEIGHT	2,1 Kg
DIMENSIONS	618 x 80 x 280 cm

* Other accessories from plumbing fixtures are available outside this catalog

TRICOISE WRENCH

EFE-03148



FEATURES

TRICOISE WRENCH

MATERIALS	Steel	STAINLESS STEEL
TYPE OF FITTINGS	From DN20 to DN120	FROM DN20 TO DN120
COLOR	Red	INOX
COATING	Epoxy resin	WITHOUT
WEIGHT	0.50 Kg	0,5 KG

POLYCOISE KEY

EFE-02438



FEATURES

"DESCHAMPS" TRICOISE WRENCH

TYPE OF FITTINGS	From DN20 to 100
WEIGHT	1 Kg
11 FUNCTIONS	<ul style="list-style-type: none"> Tightening of fittings with nominal diameters of 20 to 100. Opening EDF and GDF boxes with the 13 mm female triangle. Opening fire hydrant boxes with the 15.6 mm female triangle. Opening windows and doors without handles with the 6.5 mm female square. Opening of ventilation ducts and fire cabinets with the truncated pyramid square from 5x5 mm to 8x8 mm. Opening aluminum locks on modern bathroom doors with a screwdriver. Opening the dry column sockets with the female square of 12.5 mm. Loosening of M8, M10 and M12 nuts with the hexagonal sockets of 13, 17 and 19 mm. Opening bottles with caps with the 100 bottle opener.

FLOAT FOR STRAINER

EFE-03280



FEATURES

FLOAT EFE-02438

WEIGHT	1.560 Kg
DIMENSIONS	36 cm
MATTER	Stainless steel (chain)

WATER CURTAIN SCREEN

Used for the fire protection of tanks and equipment vulnerable to heat and spark projections. The products feature an aluminum diffusion plate equipped with grooves that ensure better jet stability in difficult weather conditions.



CARACTÉRISTIQUES

	RID-65	RID-45
NOMINAL PRESSURE	PN 16	
MATERIAL	Aluminium	
SURFACE TREATMENT	Revêtement polyester	
INLET (CONNECTION)	DN65	DN45



LIGHT STRAINER

EFE-03148



STRAINER EFE-03148

FEATURES

DIAMETER	DN40 or 65
BASKET TYPE	Aluminum, Polyethylene
FLAP	No
WEIGHT	0.6 Kg
DIMENSIONS	12 cm

PIPE STRAINER LARGE DN100

EFE-03033



STRAINER EFE-02438

FEATURES

DIAMETER	DN100
BASKET TYPE	Aluminum, Polyethylene
FLAP	Non
WEIGHT	1 Kg
DIMENSIONS	18 cm

FLAP STRAINER

EFE-02438



STRAINER EFE-02438

FEATURES

DIAMETER	DN40 or 65 Or 100
BASKET TYPE	Polyethylene, Or Aluminum
FLAP	With or without Flap
WEIGHT	According to strainer
DIMENSIONS	According to strainer

ECO STRAINER

EFE-80/7CF250



STRAINER 80/7CF250

FEATURES

DIAMETER	DN65
BASKET TYPE	Steel
FLAP	No
WEIGHT	0.78 Kg
DIMENSIONS	15 cm



Euromast, leader in the manufacture of telescopic masts and fire-fighting equipment.

Our materials and specializations

- The manufacture of **telescopic masts** for lighting, surveillance, industry, military, telecommunications, antennas...
- The manufacture of **fire pumps** high PRESSURE and low PRESSURE, for fire or flood, for agriculture and irrigation, mines, quarries...
- The manufacture of **fixed fire groups** (motor pumps + electric pumps + jockey pumps) for industrial buildings, buildings and shopping centers
- The manufacture and distribution of **Personal Protective Equipment**
- The manufacture of **towable motor pumps**, trailers for communication, trailers for site lighting, lighting during events
- The manufacture of **aluminum curtains** sliding or rolling for fire and industrial vehicles
- The distribution of **fire equipment** and safety and drainage pumps: floating motor pumps, fire hoses, valves, divisions, lighting equipment, rescue equipment, airport equipment, agricultural equipment

The Group **Fireco** worldwide Quality, Reliability and Innovation since 1975

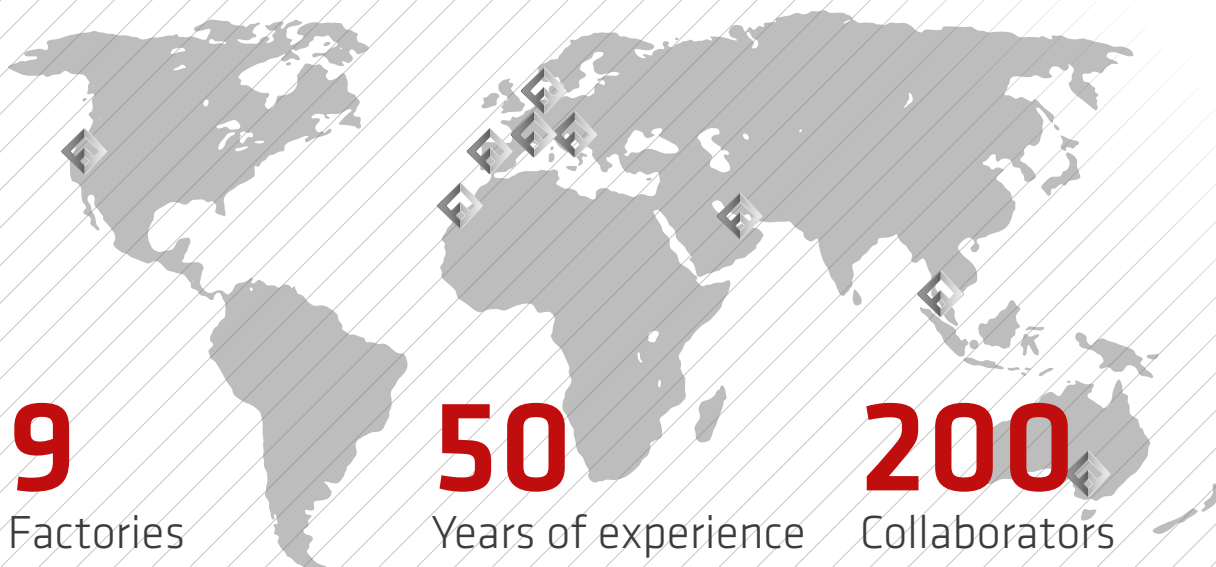



FILIALE DE FIRECO

EUROMAST

MATS TELESCOPIQUES & MATERIELS INCENDIE

Manufacture and distribution of professional fire and safety equipment

Our areas of expertise :

Telescopic Masts



www.euromast.fr

High Pressure Fire Kits



www.motopompe-incendie.com

Fire Motor Pumps



www.motopompe-incendie.com

Irrigation Motor Pumps

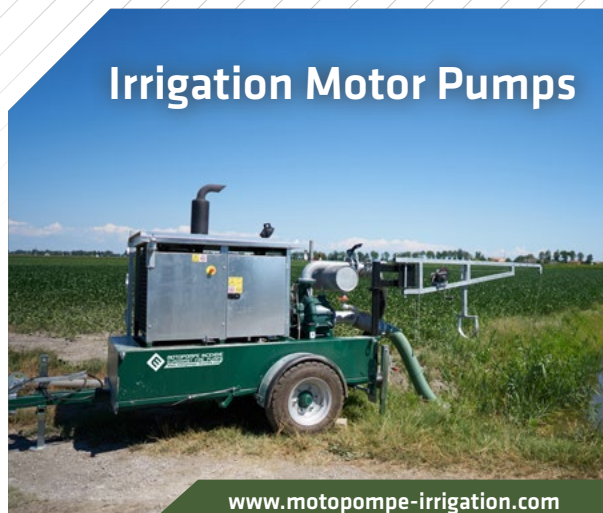

www.motopompe-irrigation.com

Equipment of Personal Protection and Fire Accessories



www.materiel-pompier.com

Curtains Vehicles



www.rideau-alu.fr



MOTOPOMPE INCENDIE
EUROMAST FIRE PUMPS



Euromast S.a.r.l.

Savoie Hexapole - 101 Rue Louis Armand
73420 MÉRY - FRANCE
fireco@euromast.fr
+33 4 79 34 92 15



WWW.MOTOPOMPE-INCENDIE.COM

